

thresholds for the unhoused

reimagining sheltered spaces as welcoming, layered environments

Catherine Evans

Through the development of thresholds to unhoused sheltered environments, this once negative experience can be transformed into a welcoming, dignified and empowering experience for an individual. The current unhoused population struggles to enter sheltered environments due to the spatial barriers that challenge their sense of self worth. Making it easier for individuals to enter sheltered spaces is crucial in the process of gaining permanent housing, by exploring how architecture, can curate a welcoming environment for everyone. Through the understanding of how architecture can create spaces that invoke inviting and inclusive feelings, a new approach to designing entry points that focuses on ease of access, dignity, and respect for everyone, no matter their housing situation, is necessary. By designing with the people that would use the space, architects can create thresholds and environments that support and uplift this marginalized community, leading to a more fair and just society.

SEMINAR FACULTY | INGRID STRONG
DESIGN AS RESEARCH FACULTY | JOHN ELLIS
FACULTY ADVISOR | MICHAEL WOLFSON
INDEPENDENT ADVISOR | REBECCA KLANCHESSER

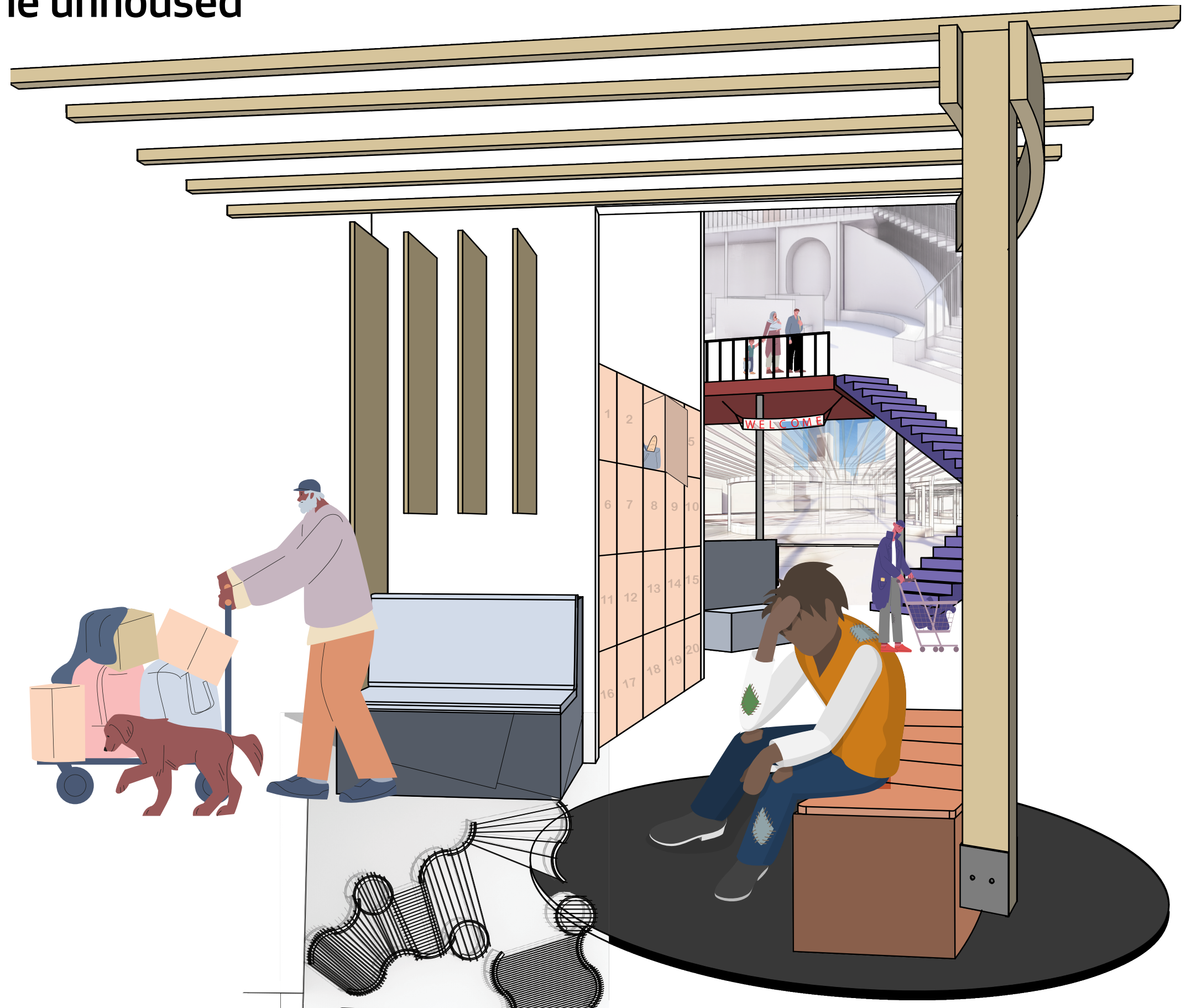

Right Realizing spaces through different modes of representation, "thresholds for the unhoused" (Catherine Evans, MArch '24, CC BY) Human Figures, Adobe Stock